



PRODUCT FEATURES

COMPACT FIXTURE HOUSING

Width: 2.0" Height: 4.0"

INDIRECT ILLUMINATION

Diffused forward-throw optics properly illuminates the wall, provides even illumination across the ceiling and protects LED's from dust and debris

ONE-PIECE EXTRUDED ALUMINUM HOUSING

Housing ensures straighter rows and consistent lens retention

120/277VAC 0-10 VOLT DIMMING TO 1% STANDARD

UP TO 152.3 LUMENS PER WATT AT 90 CRI

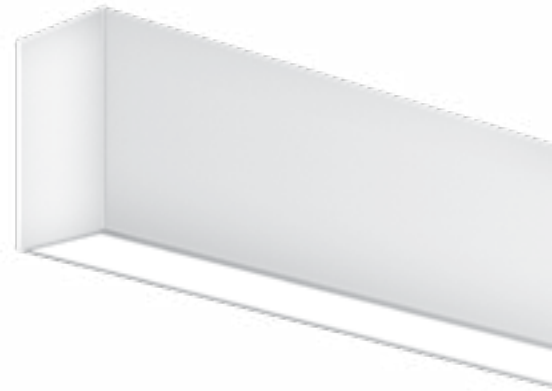

ORDERING GUIDE EX: 2WID - 20 - HU - HD - 30 - UNV - WH - C90

SERIES	LENGTH	UPPER OUTPUT	DIRECT OUTPUT	CCT	VOLTAGE	FINISH
2WID	XX FT	VHU ⁴ 1250 LM/FT LU 500 LM/FT	VHD ⁴ 1250 LM/FT LD 500 LM/FT	30 3000K	UNV 120-277V	WH White
	1' Increments EX: 20' = 20	HU 1000 LM/FT VLU 250 LM/FT	HD 1000 LM/FT VLD 250 LM/FT	35 3500K	347' 347V	BLK Black
		MU 750 LM/FT CU Custom	MD 750 LM/FT CD Custom	40 4000K		

OPTIONS

CRI	INTEGRATED CONTROLS ^{2, 3, 5}	CIRCUITING
C90	DOS Daylight Occupancy Sensor DALI DRIVER STANDARD	SS-U/D Separate Switching UPWARDS/DOWNWARDS

FOR INDIVIDUALS	FOR LINEAR RUNS ^{6, 7}					
EM ² Emergency Battery CEC LISTED	EM	QUANTITY PER RUN*	POSITION IN RUN*	EC	QUANTITY PER RUN*	POSITION IN RUN*
EC Emergency Circuit						

ORDERING NOTES

- EM NOT AVAILABLE WITH 347V.
- EM AND SENSORS ARE NOT AVAILABLE WITH 2' AND 3' FIXTURES.
- FOR INDIVIDUAL FIXTURES, SENSOR LOCATED AT POWER FEED END. FOR RUNS, A SENSOR IS INSTALLED INTO EACH FIXTURE IN RUN, EX. 2 SENSORS ARE INSTALLED IN A 16 FT RUN (1 SENSOR IN EACH 8 FT FIXTURE).
- VHD & VHU NOT AVAILABLE ON 2 FT LENGTHS.

EMERGENCY OPTION NOTES

- CONSULT FACTORY FOR COMPONENT OR SYSTEM NOT LISTED.
- EM AND EC QUANTITY IS NOT TO EXCEED NUMBER OF DISCRETE FIXTURE SECTIONS IN A ROW.
- EM AND EC POSITION REFERS TO WHICH FIXTURE IN THE RUN THAT WILL BE POWERED BY THE EM/EC CIRCUIT. POSITION OPTIONS: S=STARTER, J=JOINER, E=ENDER
EX: 2WID-20-HU-HD-35-UNV-WH-EM2SJ

STARTER	JOINER	ENDER
---------	--------	-------

PHOTOMETRICS

2WID-04-HU-HD-35-UNV-XX-C90-AU

Total Lumens: 7,939 2514
 Ratio: 50% Up & 50% Down 1885
 Wattage: 61.52 1257
 Efficacy: 129.0 LM/W 628
 Fixture Length: Four Feet

Zonal Lumen Summary

Zone	Lumens	% Fixt
0 - 30	1206.8	15.2
0 - 40	1923.4	24.2
0 - 60	3247.4	40.9
0 - 90	4054.6	51.1
90 - 180	3884.0	48.9
0 - 180	7938.6	100.0



ENERGY CONSUMPTION WATTS PER LINEAR FOOT

INDIRECT (ASYMMETRIC) / DIRECT (LAMBERTIAN) LIGHT AT 90 CRI

	VHU-VHD	VHU-HD	VHU-MD	VHU-LD	VHU-VLD	LU-VHD	LU-HD	LU-MD	LU-LD	LU-VLD
Watts/ft	19.3	17.2	14.7	12.2	10.1	14.6	12.5	10.0	7.5	5.4
Lumens/ft	2502	2254	2019	1732	1490	1754	1505	1271	984	742
LPW	129.7	131.4	137.1	142.0	147.6	120.1	120.9	126.7	131.2	137.3
	HU-VHD	HU-HD	HU-MD	HU-LD	HU-VLD	VLU-VHD	VLU-HD	VLU-MD	VLU-LD	VLU-VLD
Watts/ft	17.5	15.4	13.0	10.4	8.3	13.2	11.0	8.6	6.1	4.0
Lumens/ft	2233	1985	1750	1463	1221	1514	1266	1031	744	502
LPW	127.4	129.0	135.1	140.3	146.6	115.1	115.1	120.2	123.0	127.1
	MU-VHD	MU-HD	MU-MD	MU-LD	MU-VLD					
Watts/ft	16.0	13.8	11.4	8.9	6.8					
Lumens/ft	1976	1728	1493	1206	964					
LPW	123.7	124.9	130.9	135.8	142.2					

OPERATION

Light Engine:

The 2WID is available in 3000K, 3500K and 4000K CCT all within a 3-Step MacAdam Ellipse and has a standard CRI of 90+.

Optics:

The back lit extruded acrylic lens ensures high efficiency light output, in a minimal form factor for a clean, evenly illuminated surface with minimal glare.

Electrical:

Class 2 programmable (factory pre-set) premium power supply, 120-277VAC input. Power factor >0.9. THD <15%. Integral Surge Protection to 2KV.

Dimming:

The 2WID comes standard with 0-10V dimming to 1%. For DOS (Daylight/Occupancy Sensor) ordering code, DALI driver required. Advance Xitanium SR, 1% dimming to be utilized.

Emergency Battery Pack:

Emergency Battery Pack has been engineered to exceed UL minimum safety standards. Standard battery is CEC Listed. For most fixtures, the entire direct portion of the fixture will be illuminated by the EM Battery Pack. For 8' VHD, 10' HD and VHD, and 12' MD, HD, and VHD, only the first portion of the fixture will be illuminated by the EM battery pack. "Quantity per Run" refers to the number of fixtures in the run that will be supplied with an emergency battery pack. "Position in Run" refers to which fixture in the run that will contain the battery. Position options are Starter (S), Joiner (J), or Ender (E). For example, a 24' run needing two emergency battery packs, one in the starter and one in the joiner, would be ordered as EM2SJ. When a joiner is selected, battery packs are always supplied in 8' fixtures before 6' fixtures in that run.

Emergency Circuit:

Emergency Circuit fixtures are engineered so that the entire fixture is wired to the emergency circuit. "Quantity per Run" refers to the number of fixtures in the run that are wired to the emergency circuit. "Position in Run" refers to which fixture in the run that will be powered by the Emergency Circuit. Position options are Starter (S), Joiner (J), or Ender (E). For example, a 24' run with needing two emergency sections, one in the starter and one in the joiner, would be ordered as EC2SJ. When a joiner is selected, Emergency Circuits are always supplied in 8' fixtures before 6' fixtures in that run.

GENERAL

Warranty:

Ten (10) Year limited warranty from date of shipment.

Lumen Maintenance:

Rated for 85% initial lumen output at 90,000 Hours of operation, operated at 25°C ambient temperature; per TM-21 Guidelines published by the Illuminating Engineering Society (IES).

Certifications:

All Luminaires are UL/cUL Listed to UL 1598 Standards and approved for Indoor use in Dry/Damp Locations.

Shipping:

2-Week lead time for orders up to 1000 Linear Feet.

Lead time for orders greater than 1,000' will be determined at time of order.

Manufactured in the USA:

All ALL Luminaires and Components (with the exception of our LED boards and drivers) are proudly manufactured and assembled in the USA.

MECHANICAL

Housing Construction:

Extruded Aluminum 6063-T5 alloy outer housing with die-formed steel internal components for strength, alignment and mounting attachment. Our high-quality die-cast end caps are engineered to conceal all fasteners and to retain the sealing gaskets on the inside of the fixture while completing the clean and minimalistic look of this luminaire.

Alignment/Assembly:

The alignment system employs a seven-point alignment and attachment method, designed to create straighter rows and minimize seams between sections (field assembled). Four alignment pins ensures the outer extruded aluminum rails are aligned, two extended biscuits provide additional strength and a light shield, while a vertical draw-screw secures housing-to-housing attachment.

Lengths:

The 2WID is available in a minimum 2-foot (nominal) length with additional 1-foot increments available ($\pm 0.030"$, $\pm 0.50^\circ$). Longer fixture rows are available and will be configured with 4-foot, 5-foot, 6-foot, 7-foot, and 8-foot fixtures. Maximum run length on one power feed is 72'. Continuous runs over 72' will require a second feed.

Mounting Method/Hardware:

The Hidden-Connect design recesses or hides all attachment hardware. Standard mounting hardware includes a galvanized wall cleat with side to side adjusting for final alignment. Position all Junction Boxes in accordance with the Fixture Row Layouts found on pages 3-5. Feed Point is on the left hand mounting point for all products longer than 2'; All 2' Products have a center feed point.

Exterior Finish:

The 2WID is available in White and Black polyester powder coat finish to ensure durability.

Integrated Controls:

The 2WID is available with optional integrated controls. Sensors are conveniently designed to mount in aperture and are located at the power feed end of each fixture. For runs, each fixture section will be supplied with a discrete sensor that will control that specific section. Philips EasySense is standard daylight/occupancy sensor. DALI driver required. If your project requires a component or system not listed, please contact American Linear Lighting to review requirements.

MANUFACTURER	ORDERING CODE	SENSOR	CONNECTION	DRIVER
Philips EasySense	DOS	Daylight/PIR Occupancy	Wireless	DALI (Advanced Xitanium SR, 1% Dimming)

MOUNTING DETAILS

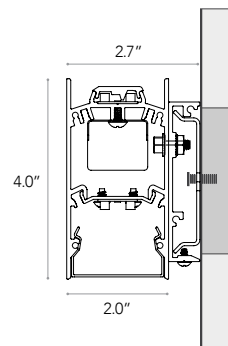

FIXTURE ROW LAYOUT: SINGLE UNIT 2' - 3' - 4' - 5' - 6' - 7' - 8' - 9' - 10' - 11' - 12'

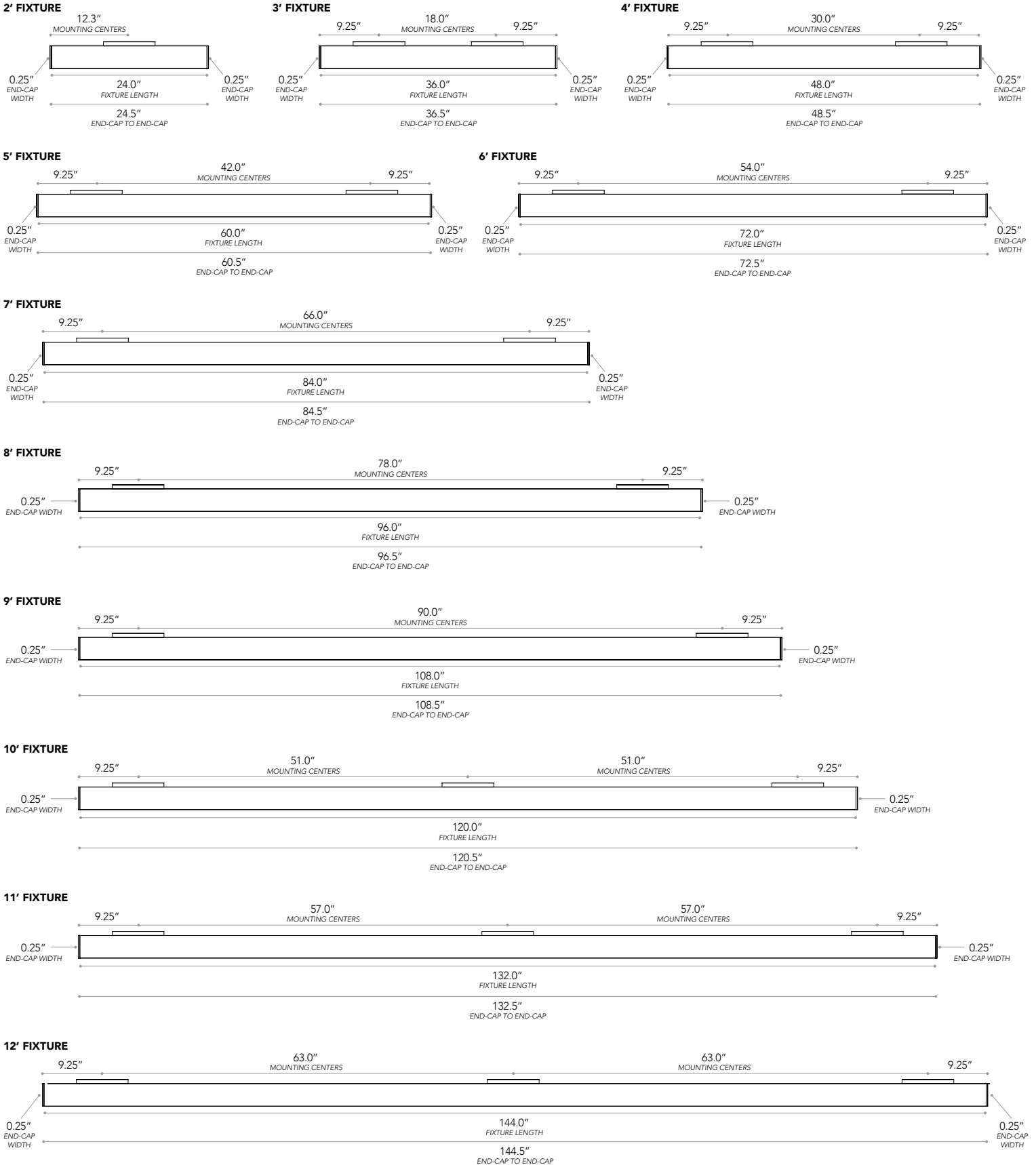

FIXTURE ROW LAYOUT: TWO UNITS 14' - 16'

14' FIXTURE

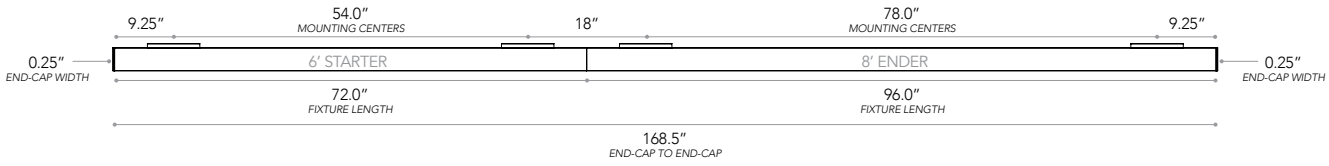

16' FIXTURE

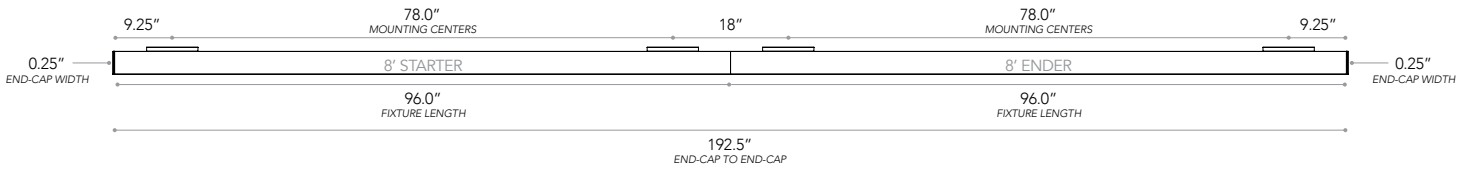

FIXTURE ROW LAYOUT: THREE UNITS 18' - 20' - 22' - 24'

18' FIXTURE

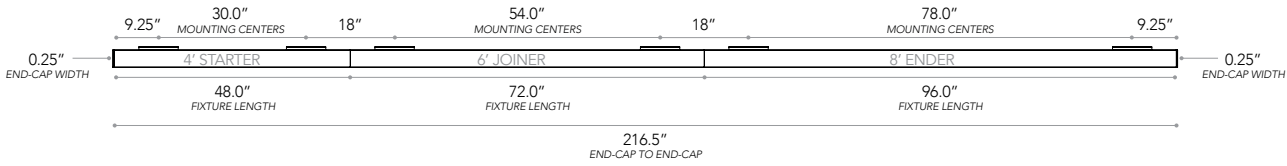

20' FIXTURE

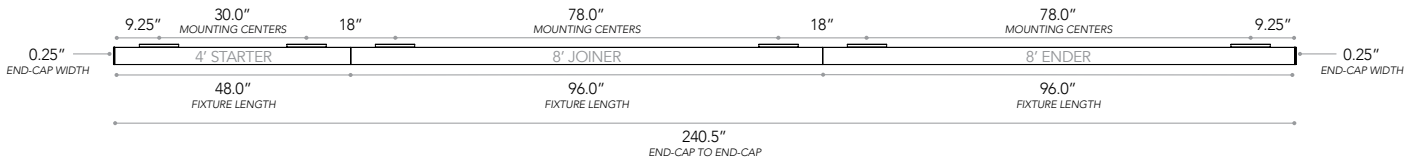

22' FIXTURE

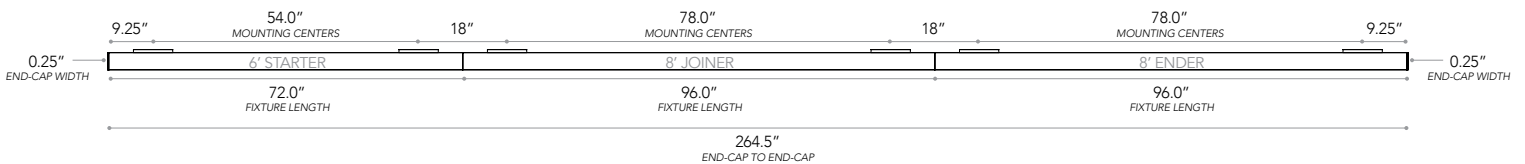

24' FIXTURE

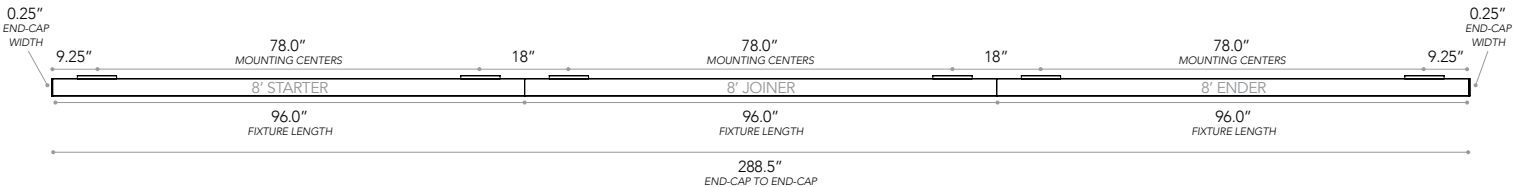

FIXTURE ROW COMPONENTS

RUN LENGTH	FIXTURE LENGTHS									JOINER KITS
	STARTER	JOINER							ENDER	
	1	2	3	4	5	6	7	8	9	
14'	6'	-	-	-	-	-	-	-	8'	1
15'	7'	-	-	-	-	-	-	-	8'	1
16'	8'	-	-	-	-	-	-	-	8'	1
17'	3'	6'	-	-	-	-	-	-	8'	2
18'	4'	6'	-	-	-	-	-	-	8'	2
19'	5'	6'	-	-	-	-	-	-	8'	2
20'	4'	8'	-	-	-	-	-	-	8'	2
21'	5'	8'	-	-	-	-	-	-	8'	2
22'	6'	8'	-	-	-	-	-	-	8'	2
23'	7'	8'	-	-	-	-	-	-	8'	2
24'	8'	8'	-	-	-	-	-	-	8'	2
25'	5'	6'	6'	-	-	-	-	-	8'	3
26'	4'	6'	8'	-	-	-	-	-	8'	3
27'	5'	6'	8'	-	-	-	-	-	8'	3
28'	4'	8'	8'	-	-	-	-	-	8'	3
29'	5'	8'	8'	-	-	-	-	-	8'	3
30'	6'	8'	8'	-	-	-	-	-	8'	3
31'	7'	8'	8'	-	-	-	-	-	8'	3
32'	8'	8'	8'	-	-	-	-	-	8'	3
33'	5'	6'	6'	8'	-	-	-	-	8'	4
34'	4'	6'	8'	8'	-	-	-	-	8'	4
35'	5'	6'	8'	8'	-	-	-	-	8'	4
36'	4'	8'	8'	8'	-	-	-	-	8'	4
37'	5'	8'	8'	8'	-	-	-	-	8'	4
38'	6'	8'	8'	8'	-	-	-	-	8'	4
39'	7'	8'	8'	8'	-	-	-	-	8'	4
40'	8'	8'	8'	8'	-	-	-	-	8'	4
41'	5'	6'	6'	8'	8'	-	-	-	8'	5
42'	4'	6'	8'	8'	8'	-	-	-	8'	5
43'	5'	6'	8'	8'	8'	-	-	-	8'	5
44'	4'	8'	8'	8'	8'	-	-	-	8'	5
45'	5'	8'	8'	8'	8'	-	-	-	8'	5
46'	6'	8'	8'	8'	8'	-	-	-	8'	5
47'	7'	8'	8'	8'	8'	-	-	-	8'	5
48'	8'	8'	8'	8'	8'	-	-	-	8'	5
49'	5'	6'	6'	8'	8'	8'	-	-	8'	6
50'	4'	6'	8'	8'	8'	8'	-	-	8'	6
51'	5'	6'	8'	8'	8'	8'	-	-	8'	6
52'	4'	8'	8'	8'	8'	8'	-	-	8'	6
53'	5'	8'	8'	8'	8'	8'	-	-	8'	6
54'	6'	8'	8'	8'	8'	8'	-	-	8'	6
55'	7'	8'	8'	8'	8'	8'	-	-	8'	6
56'	8'	8'	8'	8'	8'	8'	-	-	8'	6
57'	5'	6'	6'	8'	8'	8'	8'	-	8'	7
58'	4'	6'	8'	8'	8'	8'	8'	-	8'	7
59'	5'	6'	8'	8'	8'	8'	8'	-	8'	7
60'	4'	8'	8'	8'	8'	8'	8'	-	8'	7
61'	5'	8'	8'	8'	8'	8'	8'	-	8'	7
62'	6'	8'	8'	8'	8'	8'	8'	-	8'	7
63'	7'	8'	8'	8'	8'	8'	8'	-	8'	7
64'	8'	8'	8'	8'	8'	8'	8'	-	8'	7
65'	5'	6'	6'	8'	8'	8'	8'	8'	8'	8
66'	4'	6'	8'	8'	8'	8'	8'	8'	8'	8
67'	5'	6'	8'	8'	8'	8'	8'	8'	8'	8
68'	4'	8'	8'	8'	8'	8'	8'	8'	8'	8
69'	5'	8'	8'	8'	8'	8'	8'	8'	8'	8
70'	6'	8'	8'	8'	8'	8'	8'	8'	8'	8
71'	7'	8'	8'	8'	8'	8'	8'	8'	8'	8
72'	8'	8'	8'	8'	8'	8'	8'	8'	8'	8

	FIXTURE LENGTH	CENTER-TO-CENTER BRACKET SPACING
3'	36.0"	18.0"
4'	48.0"	30.0"
5'	60.0"	42.0"
6'	72.0"	54.0"
7'	84.0"	66.0"
8'	96.0"	78.0"

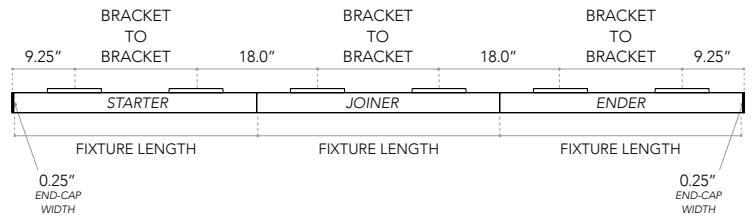

Note 1: 2' fixtures use a single mounting bracket centered on the fixture
Note 2: 10', 11', and 12' fixtures have a third mounting bracket centered on the fixture